

# PLATE WELDER

LEVEL 3 (ST0852/AP01)

1

## ON PROGRAMME DELIVERY

- Minimum 12 months, typically, 36 months duration
- Minimum 20% recorded off the job training
- Achievement of english and maths level 2
- Completion of portfolio of evidence mapped against the standards KSBS



2

## GATEWAY

- Completed training as required in the standard
- Employer satisfied that the apprentice is consistently working at or above the required level of occupational competence
- Level 2 in english and maths achieved
- Reflective portfolio available for EPAO containing production evidence
- Employer, training provider and EPAO agree EPA process



3

## SKILLS

- Employer to confirm 2 welding processes and 2 material groups for skills test
- Employer to supply WPS's for test pieces identified
- Maximum 6 hour observed practical skills test over 2 days
- Oral questioning relating to production activities to take place during the skills test
- Oral questioning to assess the required behaviours



4

## KNOWLEDGE

- Conducted under exam conditions
- Based on the curriculum set out by the international institute of welding
- 30 multiple choice knowledge questions
- All knowledge tests must achieve a minimum of 60%

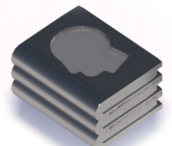

5

## BEHAVIOURS

- Assessed during professional discussion
- 60-minute professional discussion
- Questions to cover the following subjects
- Health, safety & environment
- Quality, quality system, defects, identification, and avoidance
- Materials & properties
- Welding processes, parameters & controls
- Professional integrity, collaboration, and personal & organisational development
- Documentary evidence from the apprentice's progress throughout the programme can be used to support the professional discussion

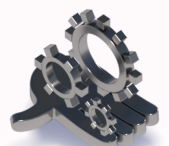

6

## OCCUPATIONAL ACHIEVEMENT

- Skills, knowledge test and professional discussion must be passed to achieve EPA
- Final grade awarded
  - fail
  - pass
  - distinction
- Results released following internal quality assurance
- Certification applied for from the ESFA and forwarded to the employer

