

1

ON PROGRAMME DELIVERY

- Minimum 12 months, typically, 48 months duration
- Minimum 20% recorded off the job training
- Achievement of english and maths level 2
- Completion of portfolio of evidence mapped against the standards KSBs



2

GATEWAY

- Complete training as required in the standard
- Employer satisfied that the apprentice is consistently working at or above the required level of occupational competence
- Level 2 in english and maths achieved
- Reflective portfolio available for EPAO containing production evidence
- Employer, training provider and EPAO agree EPA process



3

SKILLS

- Employer to confirm 2 welding processes and 4 material groups for skills test
- Employer to supply WPSs for test pieces identified
- Maximum 9 hour observed practical skills test over 2 days
- Oral questioning relating to production activities to take place during the skills test
- Oral questioning to assess the required behaviours



4

KNOWLEDGE

- Conducted under exam conditions
- Based on the curriculum set out by the international institute of welding
- 30 multiple choice knowledge questions
- All knowledge tests must achieve a minimum of 60%

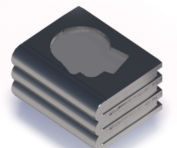

5

BEHAVIOURS

- Assessed during the 60-minute professional discussion
- Questions to cover the following subjects
 - Health, safety & environment
 - Quality, quality system, defects, identification, and avoidance
 - Materials & properties
- Welding processes, parameters & controls
- Professional integrity, collaboration, and personal & organisational development
- Documentary evidence from the apprentice's progress throughout the programme can be used to support the professional discussion

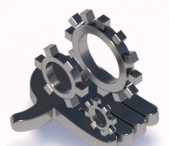

6

OCCUPATIONAL ACHIEVEMENT

- Skills, knowledge test and professional discussion must be passed to achieve EPA
- Final grade awarded:
 - fail
 - pass
 - distinction
- Results released following internal quality assurance
- Certification applied for from the ESFA and forwarded to the employer

