

1

ON PROGRAMME DELIVERY

- Typically 36 months duration, not including EPA period
- Minimum 6 hours per week recorded off the job training
- Complete agreed training programme to gain the required level of knowledge and skills
- Achievement of English and Maths level 2
- Completion of portfolio of evidence



2

GATEWAY

- Achieved a minimum level 2 English and Maths
- Satisfactory completion of the training plan agreed with the apprentice by the employer
- Sufficient evidence in the form of a portfolio to allow the apprentice to consistently demonstrate knowledge, skills and behaviours as described in the standard
- Employer satisfied that the apprentice is consistently working at or above the required level of occupational competence
- Employer, training provider and EPAO agree EPA process



3

SKILLS

- Practical observation duration based on the comparable time that a competent worker would take to complete. Typically no longer than one day
- Observed and managed by an independent assessor
- Oral questioning to confirm understanding during the observation
- Apprentices will be assessed to confirm that they can apply their knowledge of plant and systems to safely perform maintenance and operational activities with minimum supervision
- Pass, Merit and Distinction available



4

KNOWLEDGE

- Conducted under exam conditions
- 30 multiple choice knowledge questions
- Pass, Merit and Distinction available

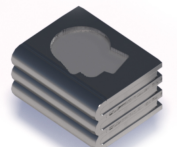

5

BEHAVIOURS

- Assessed during a technical interview
- 2 - 2.5-hour duration
- The technical interview will assess the KSBs as specified in the standards
- Portfolio of evidence can be used to support the technical interview
- Conducted by two technical experts

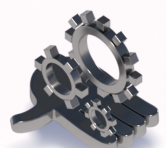

6

OCCUPATIONAL ACHIEVEMENT

- Observation, knowledge test and technical discussion must be passed to achieve EPA
- Minimum of 60% required in observation, knowledge and technical interview to achieve a pass grade
- Final grade awarded:
 - fail
 - pass
 - merit
 - distinction
- Results released following internal quality assurance
- Certification applied for from the and forwarded to the employer

SPECIFIC SKILLS ASSESSED BY ENGEPA

- Electrical Technicians
- Mechanical Technicians
- Control & Instrumentation Technicians
- Electrical Systems & Process Control Technicians
- Electromechanical Technicians
- Plant Operation Technicians

