

1

ON PROGRAMME DELIVERY

- Minimum 12 months, typically, 46 months duration
- Minimum 20% recorded off the job training
- Complete training programme to gain the required level of knowledge and skills
- Achievement of english and maths level 2
- Working towards advanced manufacturing engineering technical certificate level 3
- Completion of portfolio of evidence



2

GATEWAY

- Completed training as required in the standard
- Employer satisfied that the apprentice is consistently working at or above the required level of occupational competence
- Level 2 in english and maths achieved
- Achieved advanced manufacturing engineering technical certificate level 3
- Demonstrated competence to operate safely in a fitting environment
- Project activity agreed by employer with EPAO
- Submission of completed portfolio of evidence authenticated by the employer
- Employer, training provider and EPAO agree EPA process



3

SKILLS

- Completion of agreed project of 2000 words
- Typically, 4 weeks duration
- Project enables demonstration of the standards KSBs
- Apprentice supervised by a technical expert for duration of project
- Technical expert to provide factual report to EPAO on the project
- 60 minute questioning by assessor on submitted project



4

KNOWLEDGE

- Conducted under exam conditions
- 30 multiple choice knowledge questions
- All knowledge tests must achieve a minimum of 60%

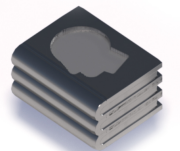

5

BEHAVIOURS

- Assessed during professional discussion
- 45 minute professional discussion
- The professional discussion will assess the KSBs as specified in the standards
- Portfolio of evidence can be used to support the professional discussion



6

OCCUPATIONAL ACHIEVEMENT

- Project, knowledge test and professional discussion must be passed to achieve EPA
- Final grade awarded:
 - fail
 - pass
 - distinction
- Results released following internal quality assurance
- Certification applied for from the and forwarded to the employer

